



Does not interfere with production

Toftejorg SaniMidget Retractor, A Retractable Rotary Spray Head

ESE00334EN 0901

Application

The Toftejorg SaniMidget Retractor is a retractable version of the Toftejorg SaniMidget rotary spray head. The tank cleaning head is automatically retracted and isolated from contact with the tank or duct contents when cleaning is complete. Machine components that come in contact with cleaning media or product are designed to be self-draining and self-cleaning.

The device is for use in tanks, vessels, dryers, and ducts where internal components or geometry complicate the placement of permanently installed cleaning machines. It is suitable for storage tanks, reactors and mixing tanks between 0.1 and 10 m³ (27 to 2,700 US gallons).

Working principle

The Toftejorg SaniMidget Retractor is available with two styles of retracting mechanisms: Pneumatic Driven, which uses air pressure to extend and retract the cleaning head, and Media Driven, which uses the pressure of the cleaning media to extend the cleaning head and an integrated spring to retract it. The cleaner head is driven by the media and starts rotating upon application of media flow, creating fans of fluid in a swirling pattern. The distribution pattern of the cleaner head generates a vibrating impact as well as cascading flow coverage of all internal surfaces of the tank.



Spray Pattern

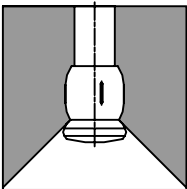

270° up

Standard Design

The Toftejorg SaniMidget Retractor is available in three stroke lengths: 100 mm, 150 mm and 250 mm, in either pneumatic- or media-driven versions.

Materials

Product area:1.4404 (316L), PEEK*
 Non-product area:1.4301 (304), POM
 Sealing:EPDM*

Technical Data

Surface finish:	Product contact surfaces: Ra0.8 µm
Weight:See reverse page
Lubricant:Self-lubricating with the cleaning media
Working pressure:2 - 5 bar (29 - 73 psi)
Recommended pressure:2 - 4 bar (29 - 58 psi)
Air supply pressure:2 - 5 bar (29 - 73 psi)
Air quality:Clean, filtered max. 40 µm. Dry, dew point max. 10°
Max. working temperature:95 °C (203 °F)
Max. ambient temperature:150 °C (304 °F)
Wetting radius:Max. 3.5 m (11 ft)
Impact cleaning radius:Max. effective 1.7 m (5 ft)

* FDA compliance 21CFR§177

Installation: Please contact Alfa Laval for
installation of the tank
cleaning machine
Standard Surface finish: Product contact parts
Ra0.8µm (32µ inch) - Non
product contact parts
Ra1.6µm (64µ inch)

Certificate:
2.1

Ordering
Please specify required connections, material selection and type of
certification required and confirm the application suitability.

Flow Rate
m³/h, USgpm

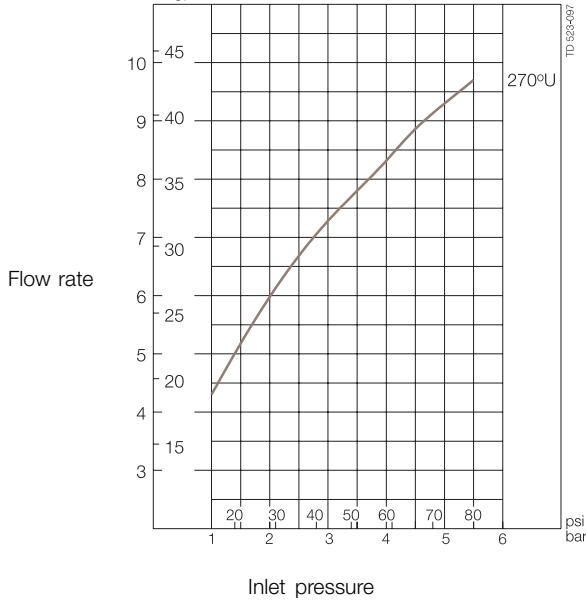

Cleaning Radius
m, ft.

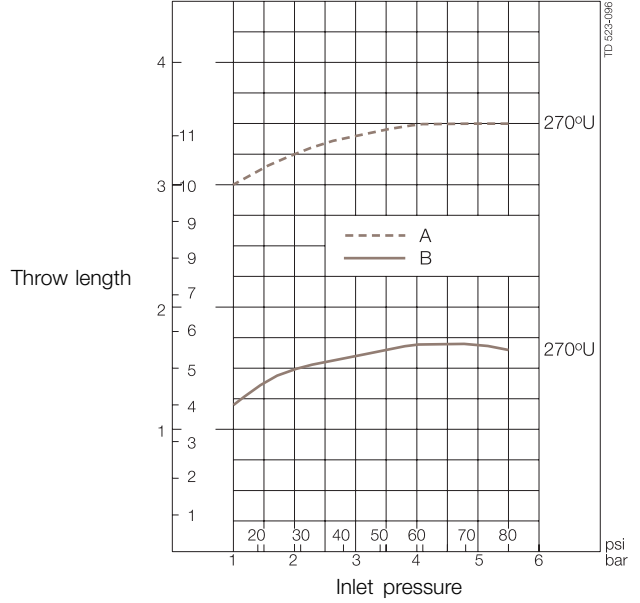

A: Wetting - B: Impact cleaning

Dimensions (mm / inch)

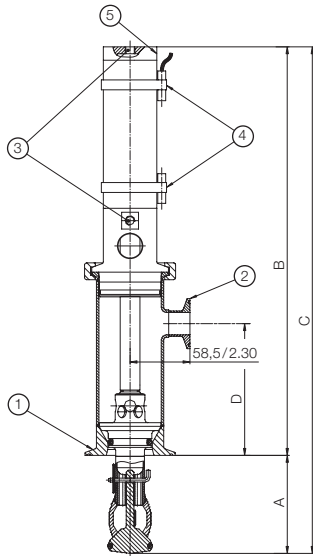

Pneumatic version

Dimensions (mm / inch)

Stroke	A	B	C	D	Weight
100	100/3.9	410/16.1	510/20.1	133/5.2	5.0 kg (11.0 lbs)
150	150/5.9	510/20.1	660/26	183/7.2	5.5 kg (12.1 lbs)
250	250/9.8	710/28	960/37.8	283/11.1	6.4 kg (14.1 lbs)



Connections

1. Tank connections
2. Cleaning media
1" Clamp ISO 2852
3. Air supply - pneumatic driven only
ISO 228-G 1/8
4. Option
Magnetic sensor
5. Adjustable valve - media driven only

Media driven

Dimensions (mm / inch)

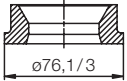
Stroke	A	B	C	D	Weight
100	100/3.9	491/19.3	591/23.3	133/5.2	5.6 kg (12.4 lbs)
150	150/5.9	621/24.4	771/30.4	183/7.2	6.3 kg (13.9 lbs)
250	250/9.8	869/34.2	1119/44.1	283/11.1	7.4 kg (16.3 lbs)

Tank Connection		
Clamp	Welded	Welded
		
3" Clamp ISO 2852	3" ISO 2037/US ø76,1/3	DN80 DIN 11.850 ø85/3.35

Options

- A. Hastelloy C22 in product contact part
- B. Alternative sealing component material, FPM*, FFKM*
- C. Positioning sensors, which generate digital signals at the fully retracted or fully extended positions
- D. 3.1.B certificate for metallic parts available upon request

* FDA compliance 21CFR§177

ESE00334EN 0901

The information contained herein is correct at the time of issue, but may be subject to change without prior notice.

How to contact Alfa Laval

Contact details for all countries are continually updated on our website. Please visit www.alfalaval.com to access the information direct.